

# 产品规格书

## Product Specification

■产品名称 (Name): MPX 公/母连接器 (MPX connector male & female)

■产品型号 (Model): AM-1016

■基本参数 (Principal Technical Data)

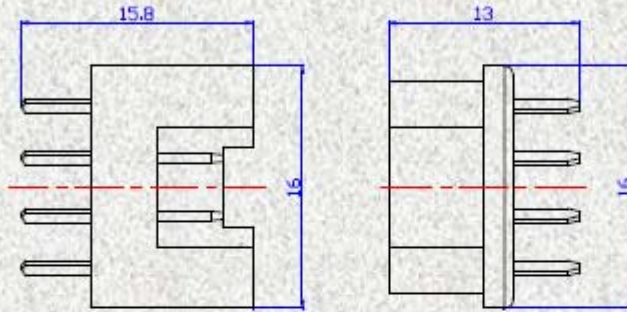
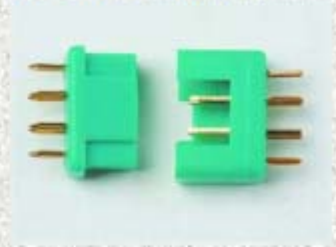

■典型特性 (Typical Characteristic)

插片材质 Inserted slice materials	H59-1	产品重量 Weight	2.4g/set
绝缘体材质 Insulation material	尼龙 PA	电流 Electric current	30A

■可供产品颜色(Available Color)



红色 (Red)



绿色 (Green)

■特点 (Feature)

◆高可靠性  
High reliability

◆高稳定性  
High stability

◆经济实用  
Economical and practical