

1/5th 4WD Gasoline Power R/C Off-Road Buggy

Specifications:

LENGTH	WIDTH	HEIGHT	WHEEL BASE	DRIVE SYSTEM	WEIGHT	DIAMETER OF WHEEL	WIDTH OF WHEEL	GEAR RATIO
800mm	480mm	275mm	575mm	4WD Shaft Drive	12.5kg	178mm	65mm	1.9.6

Spare Part

50004-Front Lower Suspension Arm	50055-Rear Lower Suspension Arm	54028-Front Upper Suspension Arm	50007-Gear Box
50100-Center Diff. Mount	50011-Centre Diff. Mount Set	50013-Caster Mount (L/R)	50014-Steering Mount
50020-Center Diff. Tray	50022-Spacer+Countersunk Screw (For Engine)	50023-Brake Discs+Pads+Pins	50024-Diff.First Way Shaft +Second Way Shaft
51006-Front Bumper	50030-Centre Dogbone Joint Cup	50031-Diff. Joint Cups (54023)	50033-Center Diff. Shaft+Washers
54072-Chassis	54006-Front Shock Tower	54007-Rear Shock Tower	50002-Front Shock Absorber(Short)

Spare Part

50029-Clutch Bell Bush	54089-Steering Joint Mount	54073-Roll Cage (unassemble)	54005-Roll Cage Light Cover(L/R)	54077-Top Plate
54074-Front Upper Top Plate/Post	54075-Fuel Tank (700CC)	50016-Fuel Pipes	54010-Fuel Tank Post W/E-Clips (82832)	54076-Rear Reinforcement Plate
54084-Rear Brace Post	54016-Brace A	54017-Brace B	54013-Wing Mount	54021-Side Wing Post W/Wing Stay
54078-Style Wing+Wing Button	54020-Style Wing +Wing Button	50051-Chargeable Battery Pack Ni-MH (6V 2500mAh)	Sp9002-Throttle Servo (9kg)(Waterproof)	Sp2004-Steering Servo (20kg) (Waterproof)
50025-Wheel Mount+Nut+Shaft(Rear)	51001-Wheels Rim Complete	51002-Tires+Insert Sponge	51003-Wheels Complete	54086-Aluminum Polished Exhaust Pipe Column Head Mechanical Screw 5*15mm

Spare Part

50083-Countersunk Head Hex.Mechanical Screw 3*10 4P	50084-Countersunk Head Hex.Mechanical Screw 4*12 12P	50085-Countersunk Head Hex.Mechanical Screw 4*16 12P	50086-Countersunk Head Hex.Mechanical Screw 4*20 8P	50087-Countersunk Head Hex.Mechanical Screw 4*25 8P
50088-Countersunk Head Hex.Mechanical Screw 5*12 12P	50089-Countersunk Head Hex.Mechanical Screw 5*15 12P	50090-Countersunk Head Hex.Mechanical Screw 5*18 4P	50091-Countersunk Head Hex.Mechanical Screw 5*20 8P	50092-Countersunk Head Hex.Mechanical Screw 5*25 4P
50100-Cap Head Hex. Mechanical Screw 3*10 8P	50101-Cap Head Hex. Mechanical Screw 3*12 12P	50103-Cap Head Hex. Mechanical Screw 4*15 8P	50104-Cap Head Hex. Mechanical Screw 4*25 4P	50105-Cap Head Hex. Mechanical Screw 4*30 4P
50106-Cap Head Hex. Mechanical Screw 5*15 10P	07170-Cap Head Hex. Mechanical Screw 4*16 8P	50203-Cap Head Hex. Mechanical Screw 3*5 8P	50093-Column Head Hex. Self-tapping Screw 3*10 12P	50202-Column Head Hex.Mechanical Screw 3*16 12P
50095-Column Head Hex. Mechanical Screw 4*30 4P	50096-Column Head Hex. Mechanical Screw 5*30 4P	50097-Column Head Hex. Mechanical Screw 5*35 6P	50098-Column Head Hex. Mechanical Screw 6*25 8P	50099-Column Head Hex. Mechanical Screw 6*40 4P

Optional

054001-Front Lower Suspension Arm(AL)	054002-Rear Lower Suspension Arm (AL)	054003-Center Diff. Mount (AL)	054004-Gear Mount (AL)	054007-Sus.Arm Short Holder(F/R)(Direct Hole)(AL)
054008-Sus. Arm Long Holder(R)(Inside Bevel Hole) (AL)	054009-Front Shock Absorber(Short)(AL)	054010-Rear Shock Absorber (Long) (AL)	054013-Center Diff. Tray (AL)	050032-Fuel Tank Cover(AL)
054018-Steering Mount(AL)	050050-Servo Saver/Steering Complete (AL)	054061-Center Dogbone 105mm (Steel)	054020-Center Dogbone 90mm (Steel)	051011-Front Upper Suspension Arm (AL)
050034-Engine Cover (AL)	VX28000-Engine (28CCPRG)	050033-Engine Recoil Star(AL)	050028-Air Filter (AL)	050040-Air Filter (AL)
054006-Rear Upper Suspension Arm (AL)	050012-Front Upper Susp. Arm (AL)	054017-Rear Shock Tower(AL)	054016-Front Shock Tower (AL)	050005-Caster Mount (L/R) (AL)

Spare Part

54024-Brake Cam Set	50053-Glow Plug	54080-Servo Link	50049-Steering Linkage	050009-Universal Drive Joint (Steel)
54011-Centre Dogbone 90MM	54071-Centre Dogbone 105MM	54079-Body Posts	50201-Buffer post (54029)	50038-Front/Rear Lower Arm Pins 6*94
50039-Rear Lower Arm Pins 6*61MM	50040-Rear Upper Arm Pins 6*45MM	50041-Front Lower Arm Pins 6*65MM	28475-Receiver 2.4GHZ (Waterproof)	50066-Diff. Gear Cover
50064-Front/Rear Diff. Shell Set	50075-Centre Diff. Gear Set	50067-Front/Rear Diff. Gear Set	50073-Diff. Crown Gear(30T)(Steel)	50074-Diff. Drive Pinion(10T)(Steel)
50072-Front/Rear Drive Pinion 11T(Old)	50071-Front/Rear Crown Gear 33T (Old)	50214-Made In Taiwan Steel Front/Rear Drive Pinion 11T (New)	50213-Made In Taiwan Steel Front/Rear Crown Gear 33T(New)	50116-Gear(25T)

Spare Part

51030-Powder Steel Gear (29T/31T/25T-B*2) (Optional)	50224-Air Filter	50225-Outside Air Filter Sponges	50226-Inside Air Filter Sponges	50227-Inside/Outside Air Filter Sponges
81013-Body Clips 2.0mm	82832-Fuel Tank Clips	50043-Sus. Arm E-Clips 4*0.8mm	50044-Shock Tower Arm E-Clips 6*0.8	50112-Front Sus. Arm Ball 10mm
50113-Rear Sus. Arm Ball 11mm	50114-Servo Link Ball 8mm	50115-Steering Link Ball 10mm	50222-Shock Upper Ball	50045-Ball Bearing (26*10*8)
50068-Ball Bearing (22*10*7)	50069-Ball Bearing (24*12*6)	50070-Ball Bearing (22*8*7)	50076-First Way Gear Washer 6*15*1.5mm	50077-Second Way Gear Washer 6*12*1.5mm
50078-Servo Washers 3*8*0.8mm	02102-Nuts(M3)	02055-Nuts(M4)	50080-Nuts(M5)	50081-Nuts(M6)

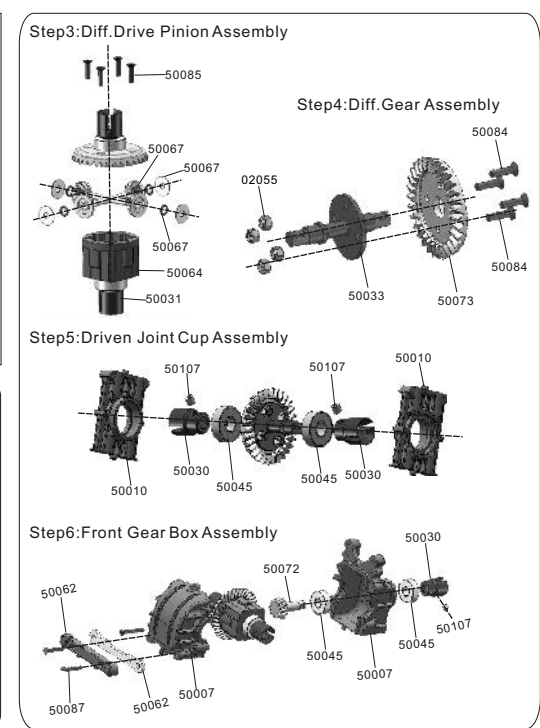
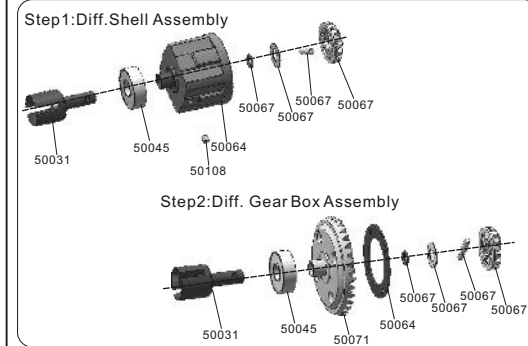
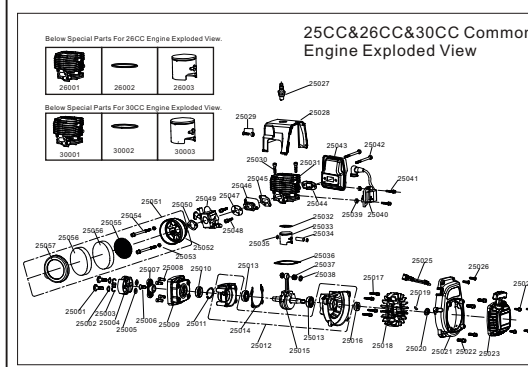

Step7:Rear Gear Box Assembly

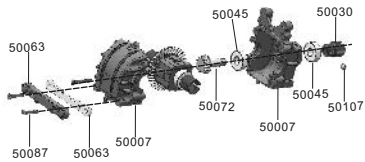

Step8:Front Shock Tower Assembly

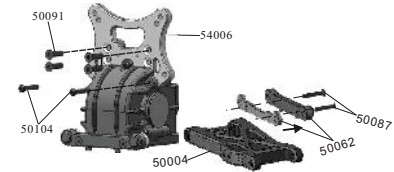

Step9:Rear Susp.Bush Assembly

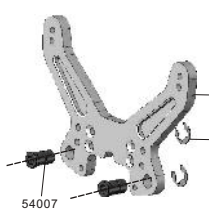

Step10:Rear Shock Tower Assembly

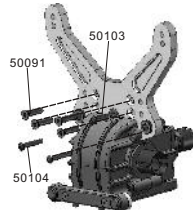

Step11:Steering Mount Assembly

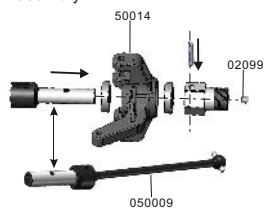

Step12:Caster Mount Assembly

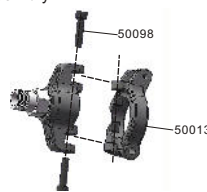

Step13:Rear Hub Carrier Assembly

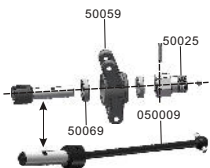

Step14:Front Upper Susp.Arm Assembly

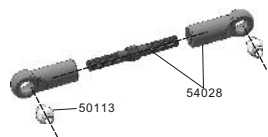

Step15:Rear Upper Susp.Arm Assembly

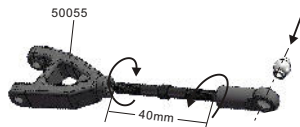

Step27:Servo Linkage Assembly

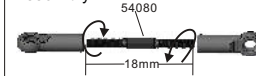

Step28:Servo Assembly

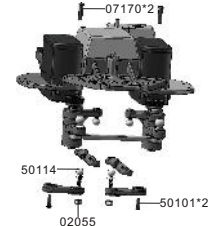

Step29:Throttle Linkage Assembly

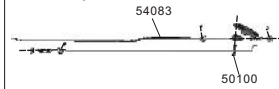

Step30:Clutch Bell Assembly

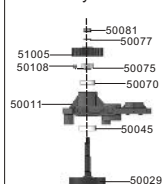

Step31:First Way Gear Assembly

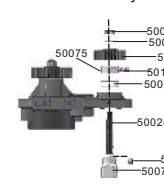

Step32:Second Way Gear Assembly

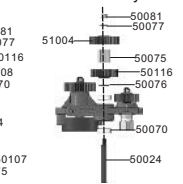

Step33: Gear Cover Assembly

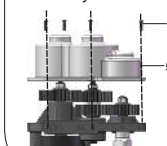

Step34:Brake Disc Assembly

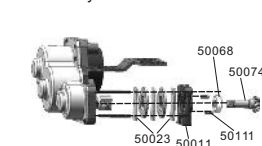

Step35:Radio Tray Assembly

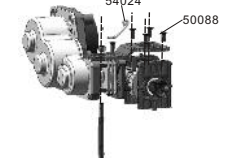

Step36:Center Diff. Gear Assembly

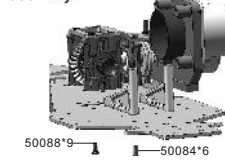

Step37:Throttle Linkage Assembly

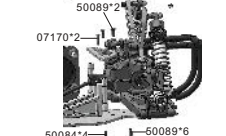

Step38:Engine Post Assembly

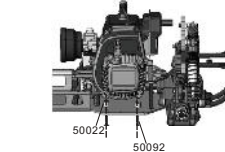

Step39:Engine Post Assembly



Step40:Brace AAssembly



Step41:Brace B Assembly

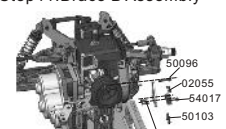

Step42:Battery Box Group Assembly



Step16:Rear Upper/Lower Susp.Arm Assembly



Step17:Front Susp.Arm&Gear Box Assembly

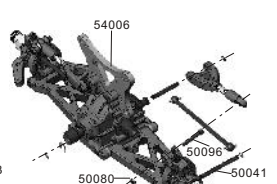

Step18:Rear Susp.Arm&Gear Box Assembly

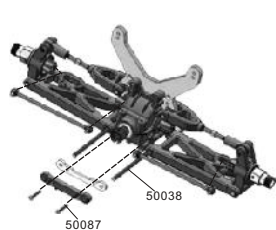

Step19:Steering Complete Assembly

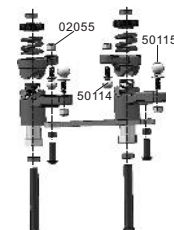

Step20:Steering Linkage Assembly

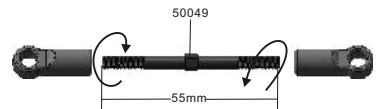

Step21:Front(Short)/Rear(Long) Shock Absorber Set

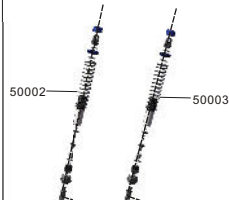

Step22:Rear Shock Absorber Assembly

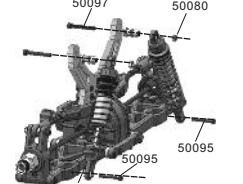

Step23:Front Shock Absorber Assembly

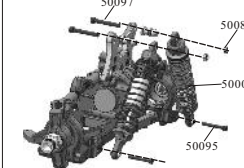

Step24:Fuel Tank Assembly

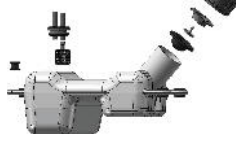

Step25:Wing Mount Assembly

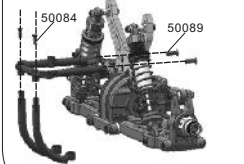

Step26:Servo Assembly

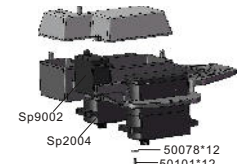

Step43:Steering Joint Mount Assembly

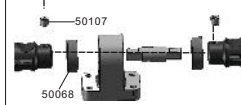

Step44:Steering Joint Mount Assembly



Step45:Fuel Tank Mount Assembly



Step46:Roll Cage Assembly

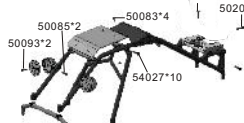

Step47:Wing Assembly



Step48:Roll Cage Assembly



Step49:Silicone Joint Tubing Assembly

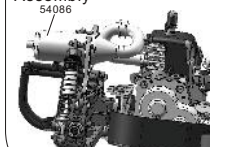

Step50:Side Guard Assembly

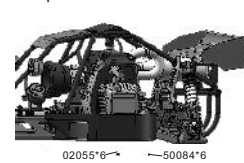

Step51:Front Unit Assembly

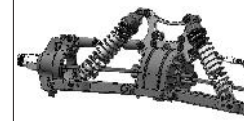

Step52:The Front Unit Assembly

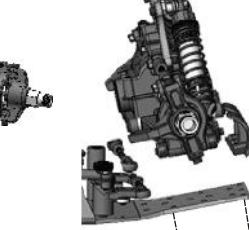

Step53:Wheels Complete Exploded View

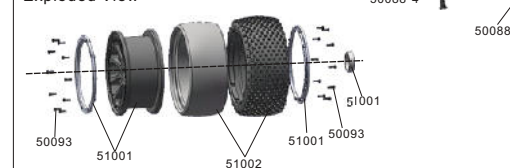

Step54:Tire Assembly

