

Aluminium - Zahnscheiben

(Riemenbreite 10 mm)

PM - AT5	Anzahl		da	BS	H	b1	B	Gewicht	Werk-
Bezeichnung	Zähne		Ø mm	Ø mm	Ø mm	mm	mm	kg	stoff
PM 21AT5/12-2	12	2	17,85	23,00	11,0	15	21,0	0,016	Aluminium
PM 21AT5/14-2	14	2	21,05	24,00	14,0	15	21,0	0,019	
PM 21AT5/15-2	15	2	22,65	27,00	16,0	15	21,0	0,021	
PM 21AT5/16-2	16	2	24,20	30,00	18,0	15	21,0	0,025	
PM 21AT5/18-2	18	2	27,40	30,00	20,0	15	21,0	0,031	
PM 21AT5/19-2	19	2	29,00	33,00	22,0	15	21,0	0,036	
PM 21AT5/20-2	20	2	30,60	33,00	23,0	15	21,0	0,038	
PM 21AT5/22-2	22	2	34,85	36,00	24,0	15	21,0	0,046	
PM 21AT5/24-2	24	2	37,00	40,00	26,0	15	21,0	0,054	
PM 21AT5/25-2	25	2	38,60	46,00	26,0	15	21,0	0,058	
PM 21AT5/26-2	26	2	40,20	46,00	26,0	15	21,0	0,062	
PM 21AT5/27-2	27	2	41,80	46,00	30,0	15	21,0	0,064	
PM 21AT5/28-2	28	2	43,35	50,00	32,0	15	21,0	0,071	
PM 21AT5/30-2	30	2	46,55	50,00	34,0	15	21,0	0,075	
PM 21AT5/32-2	32	2	49,70	55,00	38,0	15	21,0	0,088	
PM 21AT5/36-2	36	2	56,05	62,00	38,0	15	21,0	0,114	
PM 21AT5/40-2	40	2	62,45	67,00	40,0	15	21,0	0,138	
PM 21AT5/42-2	42	2	65,60	73,00	40,0	15	21,0	0,180	
PM 21AT5/44-0	44	3	68,80	-	45,0	15	21,0	0,185	
PM 21AT5/48-0	48	3	75,15	-	50,0	15	21,0	0,200	
PM 21AT5/60-0	60	3	94,25	-	65,0	15	21,0	0,307	

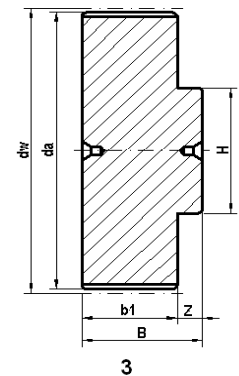
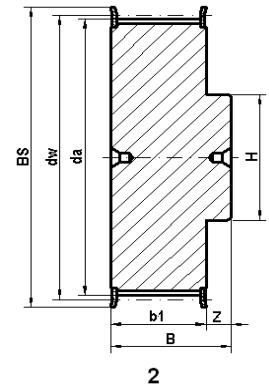

(Riemenbreite 16 mm)

PM - AT5	Anzahl		da	BS	H	b1	B	Gewicht	Werk-
Bezeichnung	Zähne		Ø mm	Ø mm	Ø mm	mm	mm	kg	stoff
PM 27AT5/12-2	12	2	17,85	23,00	11,0	21	27,0	0,022	Aluminium
PM 27AT5/14-2	14	2	21,05	24,00	14,0	21	27,0	0,026	
PM 27AT5/15-2	15	2	22,65	27,00	16,0	21	27,0	0,029	
PM 27AT5/16-2	16	2	24,20	30,00	18,0	21	27,0	0,035	
PM 27AT5/18-2	18	2	27,40	30,00	20,0	21	27,0	0,043	
PM 27AT5/19-2	19	2	29,00	33,00	22,0	21	27,0	0,049	
PM 27AT5/20-2	20	2	30,60	33,00	23,0	21	27,0	0,053	
PM 27AT5/22-2	22	2	34,85	36,00	24,0	21	27,0	0,054	
PM 27AT5/24-2	24	2	37,00	40,00	26,0	21	27,0	0,076	
PM 27AT5/25-2	25	2	38,60	46,00	26,0	21	27,0	0,081	
PM 27AT5/26-2	26	2	40,20	46,00	26,0	21	27,0	0,085	
PM 27AT5/27-2	27	2	41,80	46,00	30,0	21	27,0	0,090	
PM 27AT5/28-2	28	2	43,35	50,00	32,0	21	27,0	0,092	
PM 27AT5/30-2	30	2	46,55	50,00	34,0	21	27,0	0,105	
PM 27AT5/32-2	32	2	49,70	55,00	38,0	21	27,0	0,123	
PM 27AT5/36-2	36	2	56,05	62,00	38,0	21	27,0	0,160	
PM 27AT5/40-2	40	2	62,45	67,00	40,0	21	27,0	0,193	
PM 27AT5/42-2	42	2	65,60	73,00	40,0	21	27,0	0,205	
PM 27AT5/44-0	44	3	68,80	-	45,0	21	27,0	0,228	
PM 27AT5/48-0	48	3	75,15	-	50,0	21	27,0	0,280	
PM 27AT5/60-0	60	3	94,25	-	65,0	21	27,0	0,430	

Aluminium - Zahnscheiben

(Riemenbreite 25 mm)

PM - AT5	Anzahl		da	BS	H	b1	B	Gewicht	Werkstoff
Bezeichnung	Zähne		Ø mm	Ø mm	Ø mm	mm	mm	kg	
PM 36AT5/12-2	12	2	17,85	23,00	11,0	30	36,0	0,031	Aluminium
PM 36AT5/14-2	14	2	21,05	24,00	14,0	30	36,0	0,037	
PM 36AT5/15-2	15	2	22,65	27,00	16,0	30	36,0	0,041	
PM 36AT5/16-2	16	2	24,20	30,00	18,0	30	36,0	0,050	
PM 36AT5/18-2	18	2	27,40	30,00	20,0	30	36,0	0,061	
PM 36AT5/19-2	19	2	29,00	33,00	22,0	30	36,0	0,070	
PM 36AT5/20-2	20	2	30,60	33,00	23,0	30	36,0	0,076	
PM 36AT5/22-2	22	2	34,85	36,00	24,0	30	36,0	0,080	
PM 36AT5/24-2	24	2	37,00	40,00	26,0	30	36,0	0,109	
PM 36AT5/25-2	25	2	38,60	46,00	26,0	30	36,0	0,116	
PM 36AT5/26-2	26	2	40,20	46,00	26,0	30	36,0	0,120	
PM 36AT5/27-2	27	2	41,80	46,00	30,0	30	36,0	0,128	
PM 36AT5/28-2	28	2	43,35	50,00	32,0	30	36,0	0,135	
PM 36AT5/30-2	30	2	46,55	50,00	34,0	30	36,0	0,150	
PM 36AT5/32-2	32	2	49,70	55,00	38,0	30	36,0	0,176	
PM 36AT5/36-2	36	2	56,05	62,00	38,0	30	36,0	0,230	
PM 36AT5/40-2	40	2	62,45	67,00	40,0	30	36,0	0,276	
PM 36AT5/42-2	42	2	65,60	73,00	40,0	30	36,0	0,284	
PM 36AT5/44-0	44	3	68,80	-	45,0	30	36,0	0,315	
PM 36AT5/48-0	48	3	75,15	-	50,0	30	36,0	0,400	
PM 36AT5/60-0	60	3	94,25	-	65,0	30	36,0	0,614	

